

# VUE

## REFINED FIXED WOOD SHELVING SYSTEM

---

### What is VUE Shelving?

VUE is the most advanced fixed wood storage system on the market. It provides the look and strength homeowners and residents expect. **No exposed hardware and patent-pending gap-free installation** creates a clean, polished look. VUE is the perfect setup up from ventilated wire while staying within budget.



**MEETS MARKET DEMAND**



**GAP-FREE INSTALLATION**



**SUPERIOR STRENGTH**

# VUE

## REFINED FIXED WOOD SHELVING SYSTEM

---

### Why Choose or Specify VUE?

- New patent-pending design for gap-free installation.
- No exposed screws create a clean, polished look.
- Installs after paint and requires no painting or caulking. No blocking necessary.
- Installs easily into metal or wood studs.
- Patented Tri-Loc anchor hardware and heavy duty brackets for superior strength.
- Manufactured with  $\frac{3}{4}$ " thick thermal laminate board shelving with radius edge-banding.
- Green manufacturing.....
- No harmful VOCs.
- **Seamlessly integrated and supported by our Bid360 and Closet Selector softwares.**



# Single Family | Multifamily

EXCELLENT OPTION FOR BOTH MARKETS

---

## Single Family

- Ease of installation – **“New Pro” friendly.**
- Available as Job Orders from Closet Selector – **direct to you components for single homes.**
- Provides builders and homeowners with the perfect, built-in wood system that is a step up from Wire.
- Clean finish makes closets look and feel like a true, traditional built-in system.
- Upgrade options including towers w/ drawers and baskets.
- “The New Standard”.

## Multifamily

- Ease of installation – **installs as fast as wire with use of installation template.**
- Optimized parts and pieces – we’ve designed VUE with multifamily developments in mind. **Pack sizes, shelf lengths, shipping boxes, all optimized** to make it easier to get in and out of MF developments.
- Provides ODs with economical shelf and rod solutions that differentiates properties and satisfies residents, especially above wire shelving.
- Stock-able materials so there’s no sacrificing of time and budgets.

# VUE Storage System

EXAMPLE OF FINAL INSTALLED PRODUCT

---

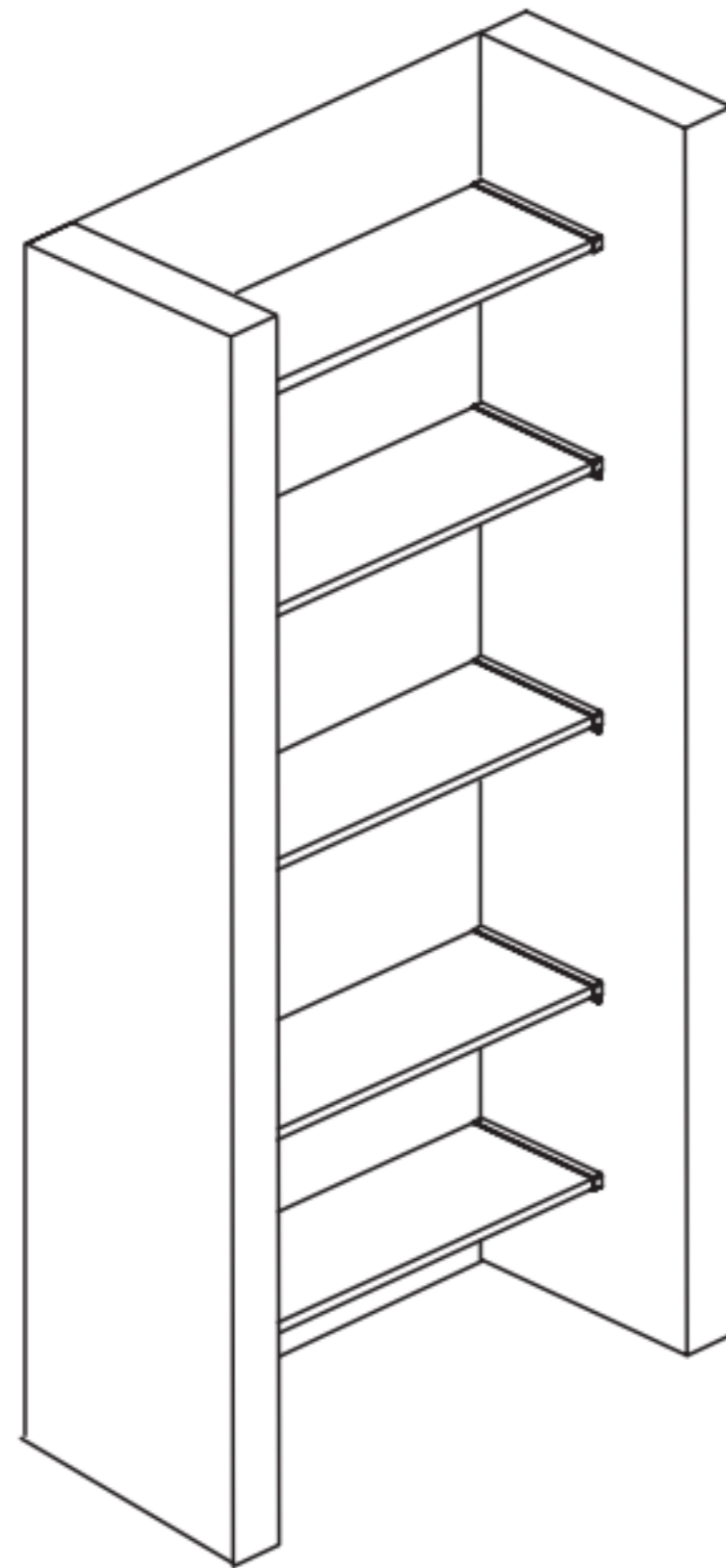

No Shelf Brackets needed in <36" wall-to-wall reach-in closets.

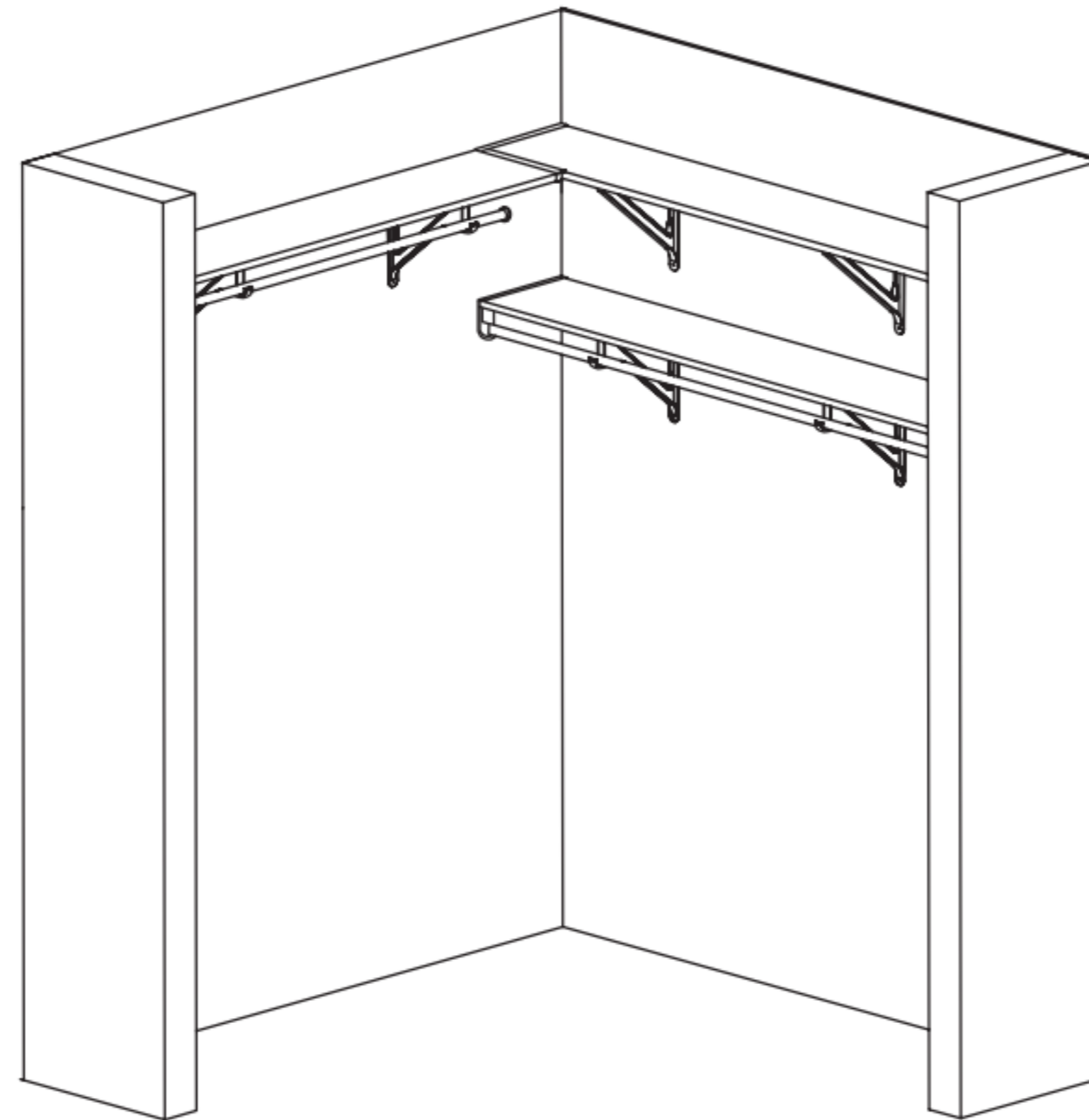

Economically maximize storage space with wall-to-wall single hang and double hang storage. No exposed hardware for a clean, polished look.

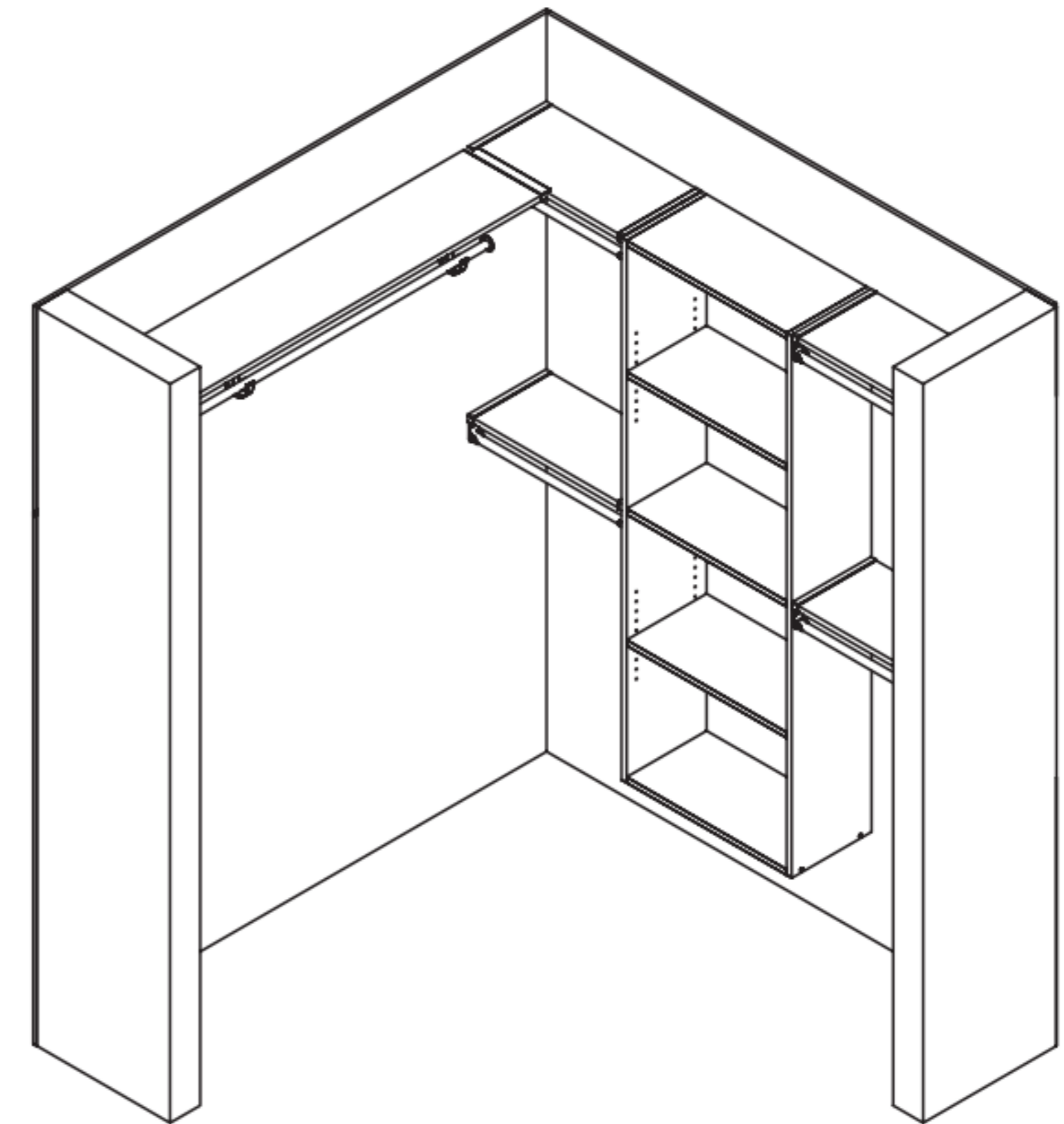

Upgrade a walk-in closet with a VUE Shelf Tower (accessories available).

# VUE Shelving Options

## 2 SHELF OPTIONS

### Shelving Details

- Shelves are designed to accommodate all areas of the home – 12" for typical hanging setups and 16" for typical **non-hanging** such as pantries or linen closets.
- 12" depth is standard.
- 16" depth are available to accommodate additional storage needs where required.
- All shelf types meet 85lbs per linear foot hold strength.
- **78" and 96" length options.** Please note that only 78" length is currently available in Bid360.

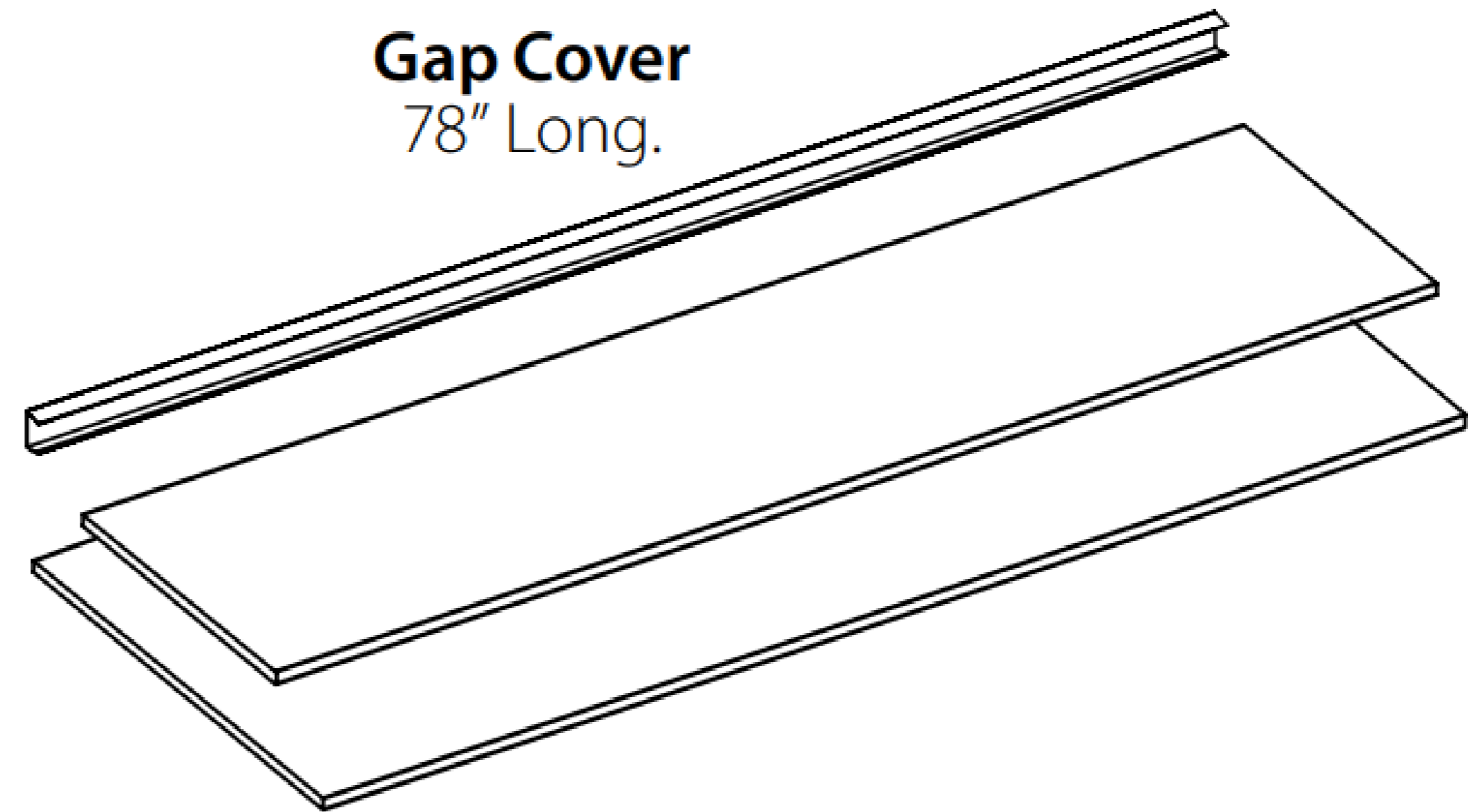

# VUE Mounting Hardware

GAP-FREE PROPRIETARY HARDWARE AND ANCHORING SYSTEMS

---

## Hardware Details

- Mounting hardware is a combination of Shelf Brackets, available in non-hanging and hanging (including both Open Slide and non-Open Slide rods).
- Sidewall Brackets available for non-hanging in both 12" and 16" depths, and right and left Sidewall Brackets for hanging.
- **All mounting hardware features exposable adhesive to secure shelves – no shelf screws required!**
- Bid360 and Closet Selector softwares will **auto-calculate and optimize** the appropriate hardware quantities.

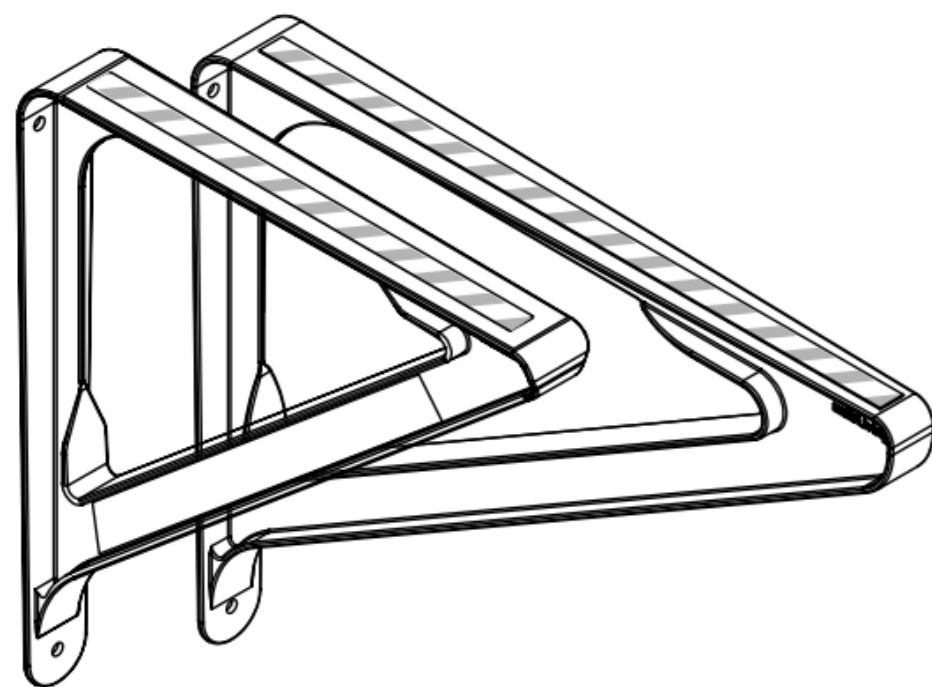

**12" Shelf Bracket**  
**16" Shelf Bracket**  
Available in White and Nickel.

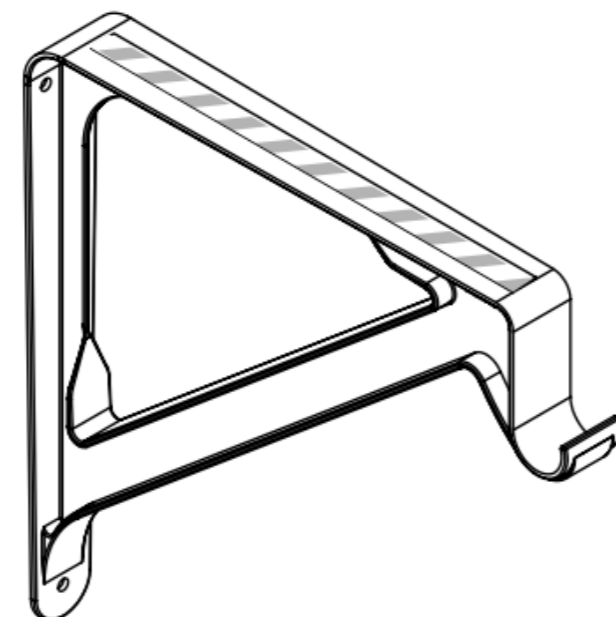

**Shelf Bracket with Rod**  
For 12" Deep Shelves.  
Available in White only.

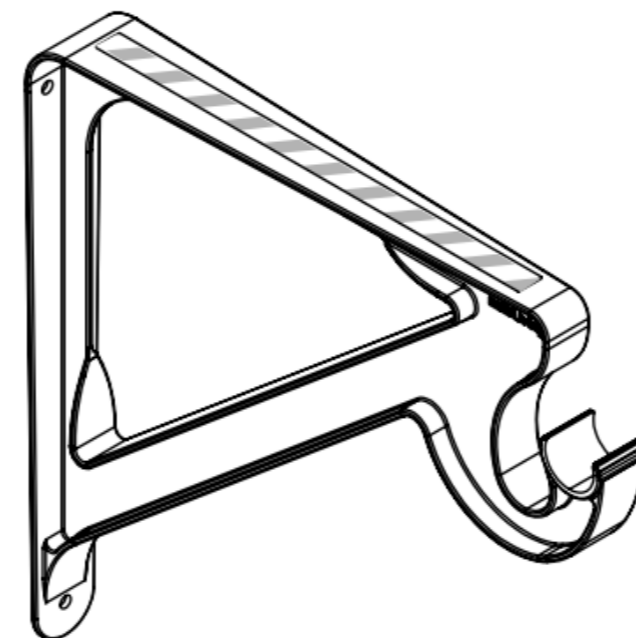

**Shelf Bracket with Open Slide Rod**  
For 12" Deep Shelves.  
Available in White and Nickel.

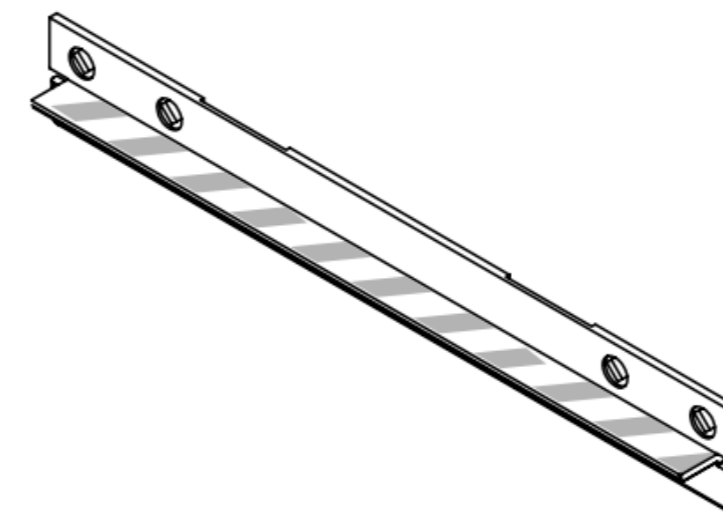

**Sidewall Bracket**  
For 12" and 16" Deep Shelves.  
Available in White and Nickel.

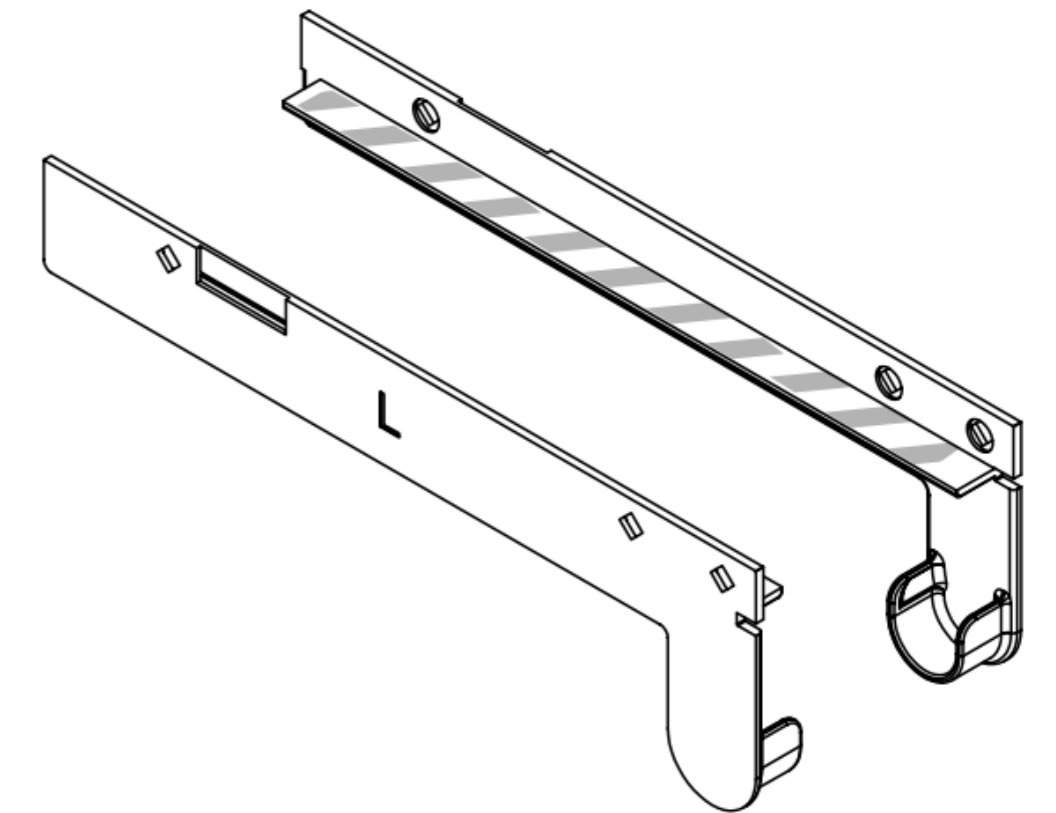

**Sidewall Bracket with Rod – Left**  
**Sidewall Bracket with Rod – Right**  
For 12" Deep Shelves.  
Available in White and Nickel.  
Sold separately.

# VUE Gap-Free Hardware

HARDWARE SUPPORTS GAP-FREE INSTALLATION

---

## Hardware Details

- Additional hardware is focused on providing a gap-free installation regardless of closet design or setup! **No need to worry about rough-cuts.**
- Shelf Joiners for linear runs of multiple shelves.
- Corner Shelf Joiners for connecting 12" shelves in L-Shaped corners (16" currently in development).
- Newly introduced Field Cut Covers (VUE is now available as open-ends).
- Sidewall Bracket Covers snap into place over 12" and 16" shelves.

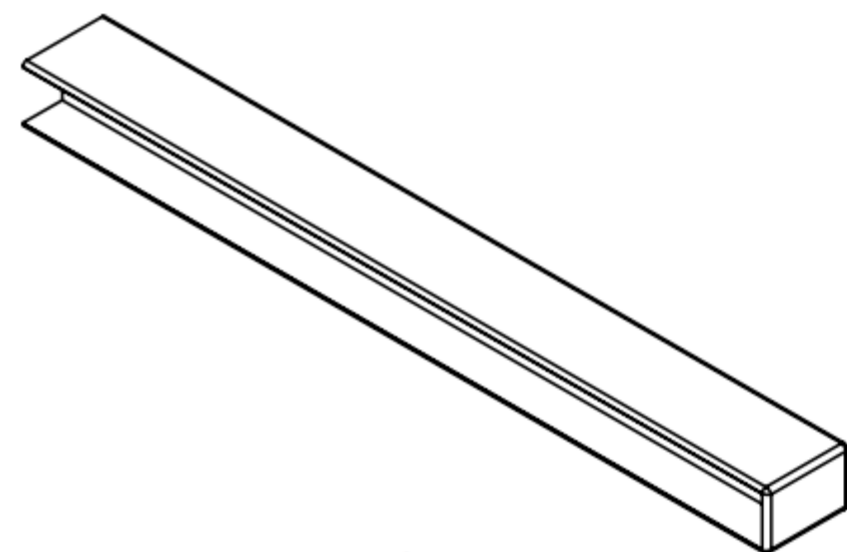

**Shelf Joiner**  
Joins 12" Deep Shelves.  
Available in White and Nickel.

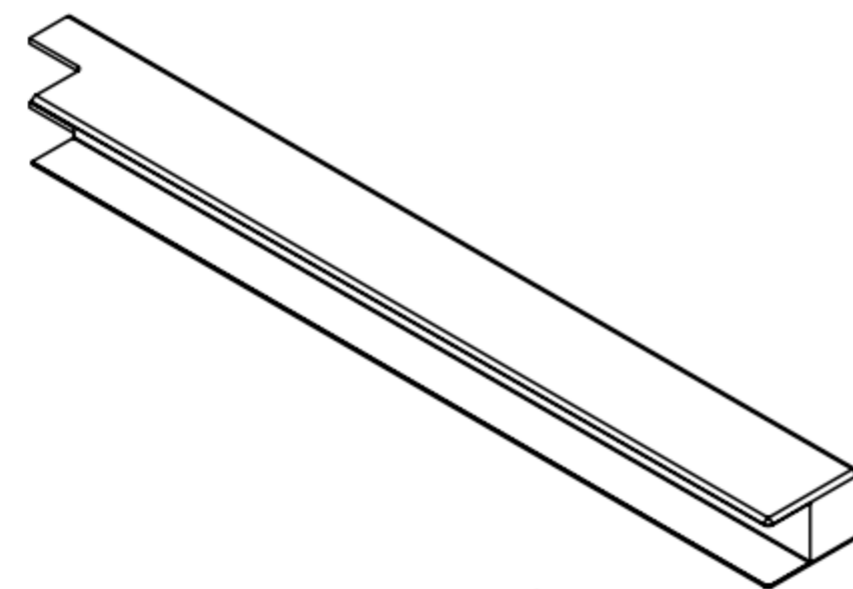

**Corner Shelf Joiner**  
Joins 12" Deep Shelves in a corner.  
Available in White and Nickel.

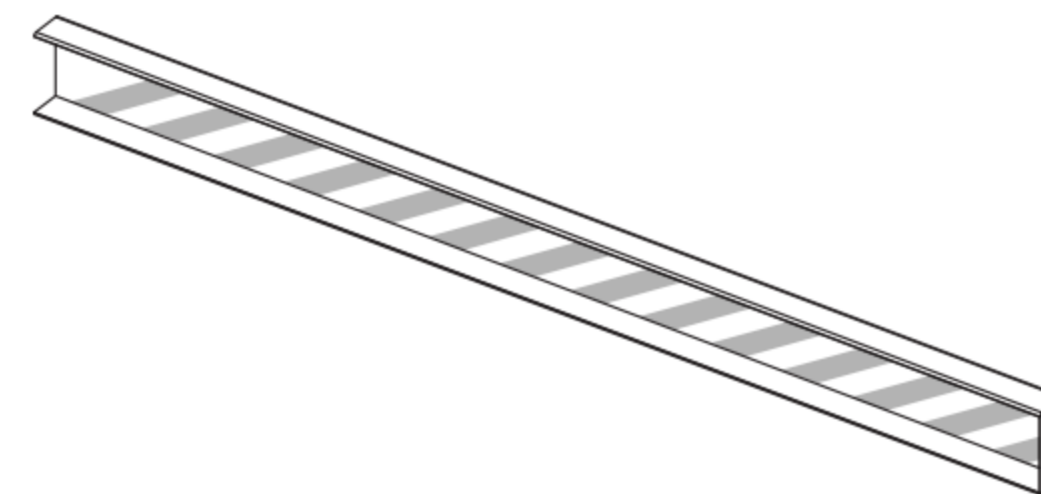

**Field-Cut Cover**  
For 12" Deep Shelves.  
Available in White, Century Gray, and  
Chocolate Pear.

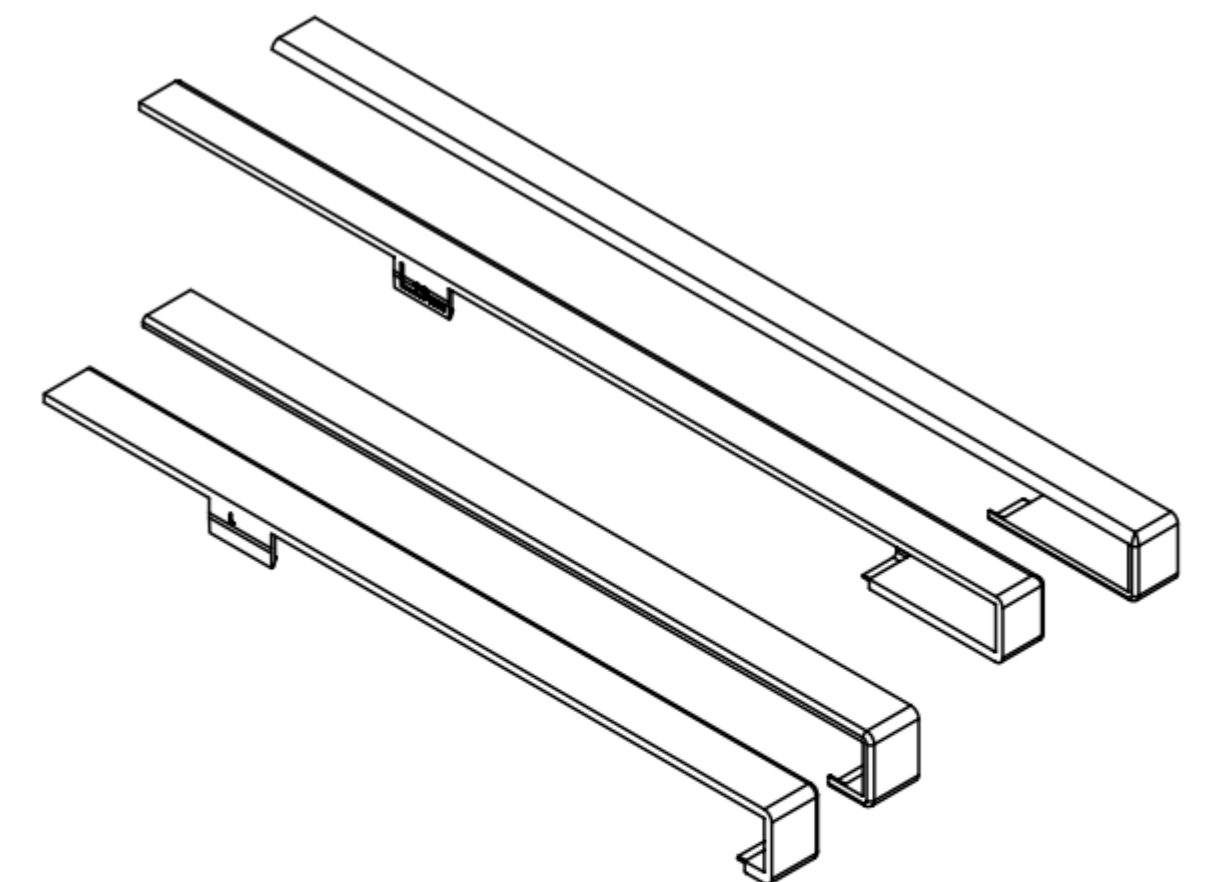

**12" Sidewall Bracket Covers** – Left  
**12" Sidewall Bracket Covers** – Right  
**16" Sidewall Bracket Covers** – Left  
**16" Sidewall Bracket Covers** – Right  
Available in White and Nickel.  
Sold separately.

# VUE Additional Components

PERFECT MATCH FOR HOMEOWNERS AND RESIDENTS ALIKE

---

## Component Details

- Rods, Corner Rods, Joiners, and Rod Stops all available in both White and Nickel.

### COMPONENTS

#### WHITE CLOTHES ROD

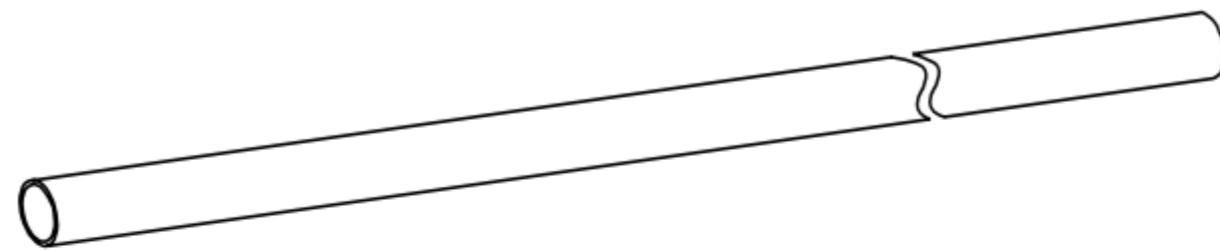

**White Clothes Rod**  
78" Long

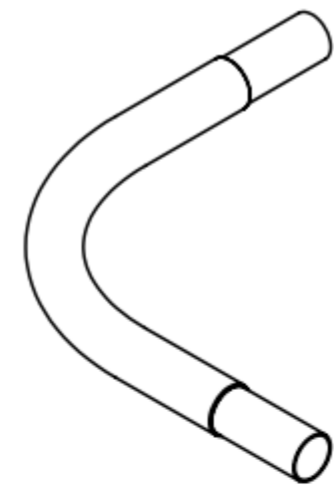

**White Corner Clothes Rod**

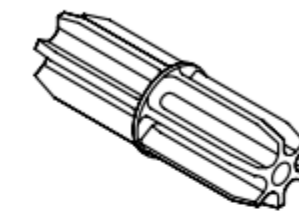

**White Clothes Rod Joiner**  
For White Rod only.

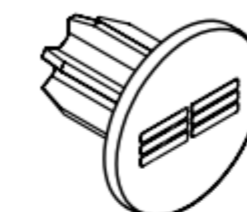

**White Rod Stop**  
For White Rod only.

#### CHROME CLOTHES ROD

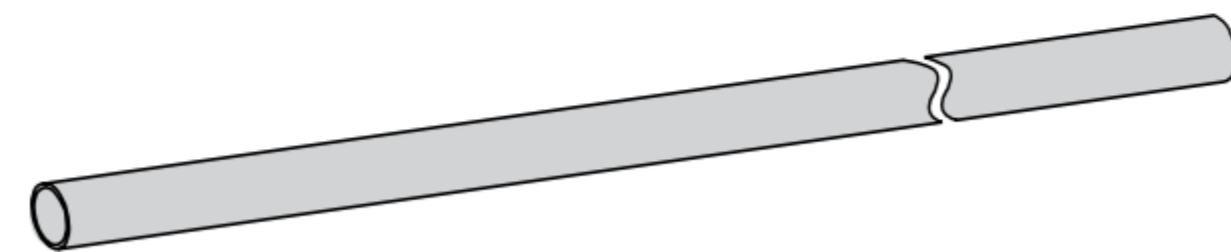

**Chrome Clothes Rod**  
78" Long

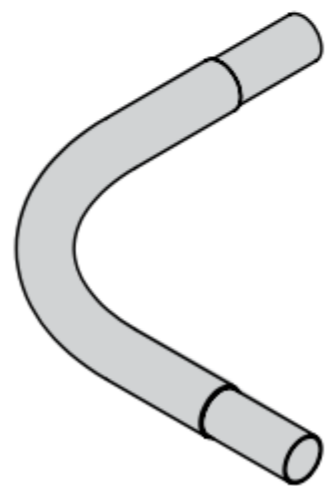

**Chrome Corner Clothes Rod**

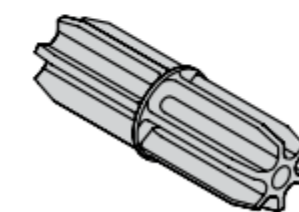

**Chrome Clothes Rod Joiner**  
For Chrome Rod only.

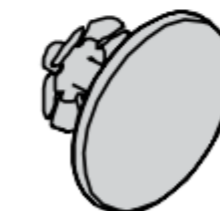

**Chrome Rod Stop**  
For Chrome Rod only.



**Corner Clothes Rod Clip**  
Supports Corner Clothes Rod.  
Available in White and Nickel.



# VUE Installation Hardware

PROPRIETARY HARDWARE AND ANCHORING SYSTEMS

---

## Hardware Details

- Tri-Loc II anchor and Cap Screws work seamlessly together to secure Sidewall Brackets.
- Self-piercing Cap Screws are ideal for both wood and metal studs (Shelf Brackets require direct into stud installation).
- Screw Cap fits perfectly over Cap Screw head for the complete, no-exposed-hardware finish.

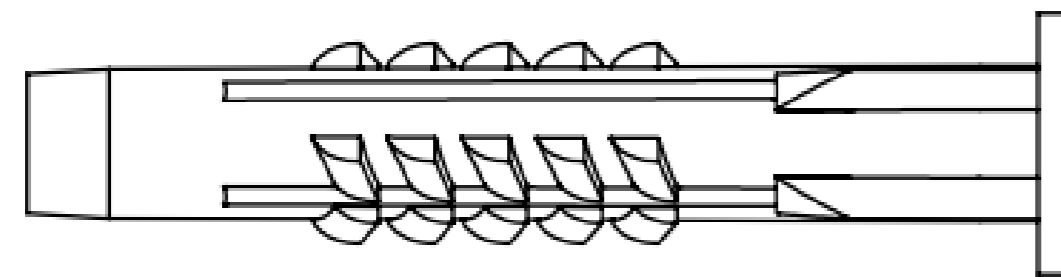

**Tri-Loc® II Anchor**



**Cap Screws**

Universal for Wood, Metal and Anchor.



**Screw Cap**

Available in White and Nickel.